



Fish Friendly Tide Gate

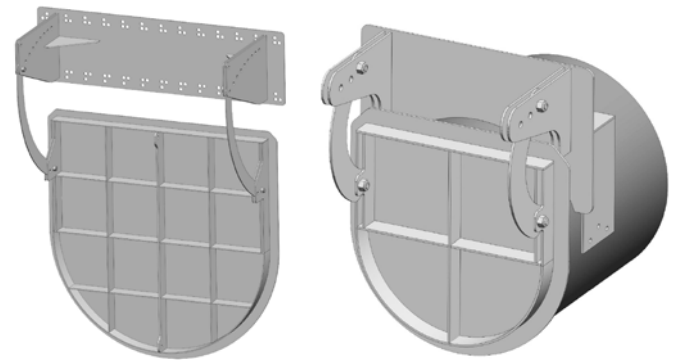
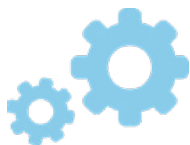

Fig 1: Headwall mounted. Fig 2: Pipe mounted.

Engineered for performance. Designed for nature.

ATS Tide Gates are fully functional and enable fish passage across a wide range of applications - combining performance with ecological sensitivity.



TECHNICAL SPECIFICATIONS

- **Flap Type:** Free-swinging double-hinge mechanism
- **Material:** 316 stainless steel (other if required)
- **Delay:** Adjustable via hinge position
- **Sizes:** Custom-built to match existing structures
- **Fixings:** M16×100 mm wedge anchors (or equal)
- **Hinge:** Adjustable offset & tilt
- **Fabrication:** Laser-cut 5 & 10 mm components

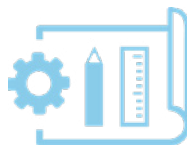

KEY ATTRIBUTES

- Fully automated function - no manual resets required.
- No floats, springs, cables or cams to fail
- Minimal head-loss - easy opening
- Low maintenance
- Extends flap-open periods for fish passage
- Effective in all flows
- Suits both new-builds and retrofits
- Allows tidal flow and flushing



INSTALLATION OPTIONS

- Direct fit to headwalls or pipe mounted
- Supplied with installation guidelines or ATS-led install
- Can easily be adjusted post-installation to suit local or seasonal requirements
- Can be easily customised to suit unusual structures